

hello, I'm

AlfredTM

Installation Guide

Please read me carefully before using.



DB2-B

Alfred

DB2-B

Installation guide

Alfred INC. reserves all rights for the final interpretation to this instruction.

⚠ All design and specifications are subject to change without notice

Specifications

Outside escutcheon

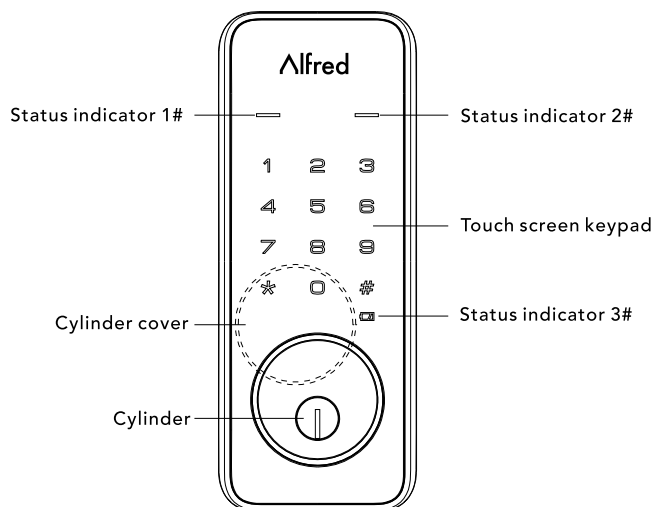

Inside escutcheon

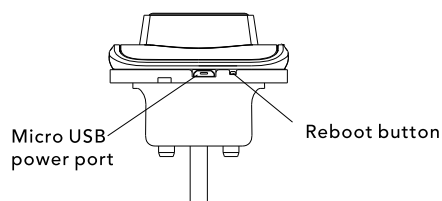
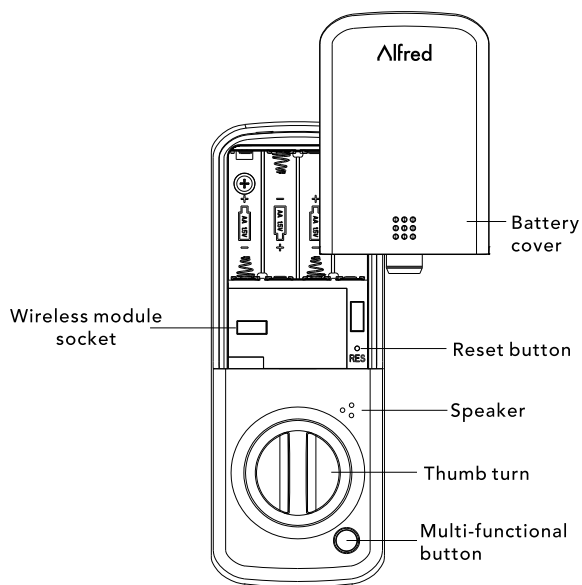

Status Indicators
1#. Door secured
2#. Door opened
3#. Low battery Warning

Components



Outside
escutcheon

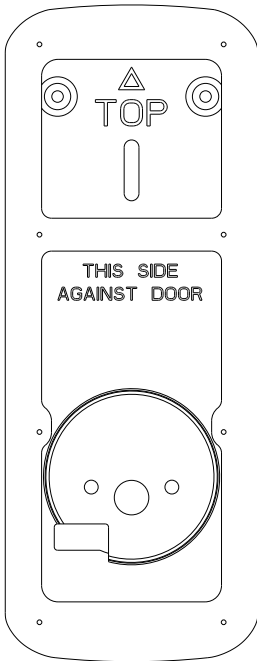

Mounting plate

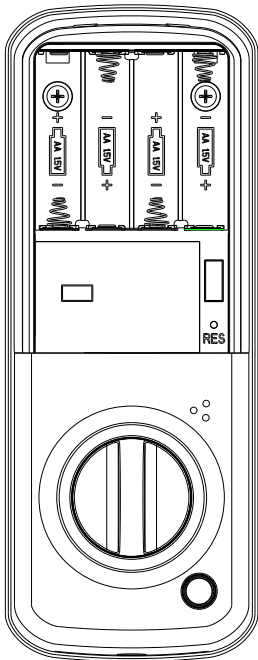

Inside
escutcheon

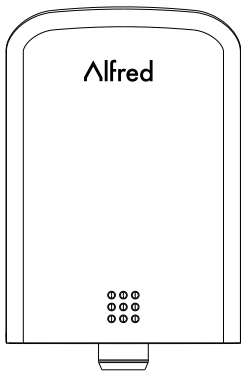

Battery cover

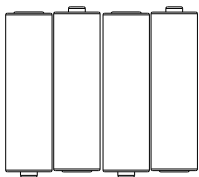

X4
AA alkaline battery

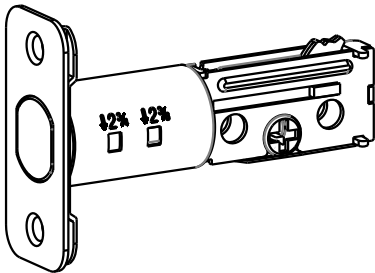

Latch bolt

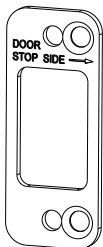

Reinforcement
Plate

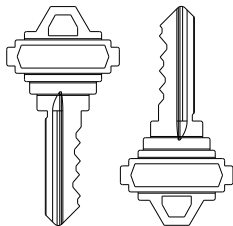

Override key X2

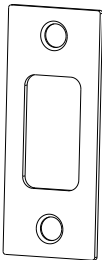

Strike plate

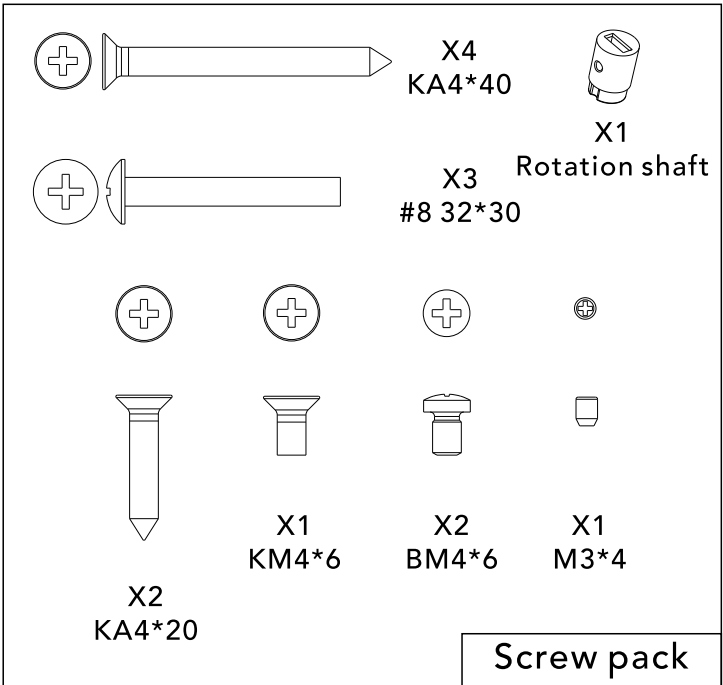

Preparing for Installation

Tools Needed

Door prep

1. 2-1/8" 53mm hole saw
2. 1" 26mm boring bit
3. 7/64" 2.5mm drill bit
4. 3/8" 10mm drill bit
5. Chisel&Hammer

Lock Installation

#2 Philips screwdriver

PREPARE LOCK FOR INSTALLATION

Unpack the Lock

A. Inside escutcheon

B. Confirm door direction.



There is a switch on back side of Inside escutcheon.
The position of switch should toward door frame(see picture at right).

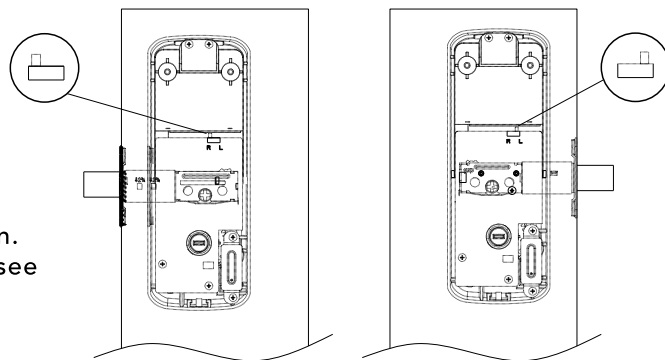

C. Bolt

Note: Bolt ships with backset in 2-3/8" position. If required, turn the bolt case and pull to extend to 2-3/4" backset position.(see pictures below)



The bolt must be in retracted(Unlocked) position when you are changing backset.

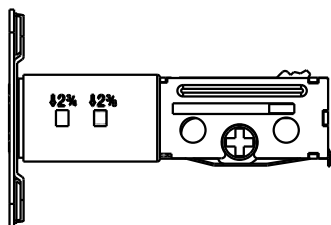

2³/₈

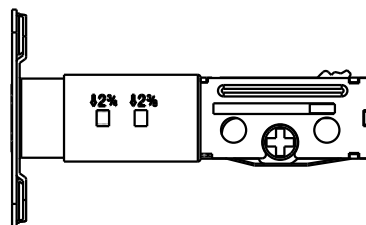
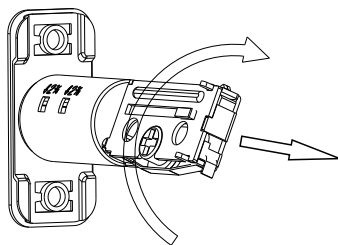

2³/₄

D. Outside escutcheon

Remains assembled.

Installation

1. Install bolt in door

 **NOTE:** The bolt must be in retracted(Unlocked) position when installing the lockset.

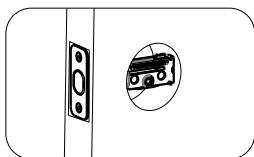
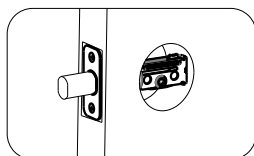

2. Install strike on the door frame.

 **NOTE:** Make sure to allow for the bolt to be centered in the strike.

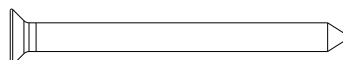
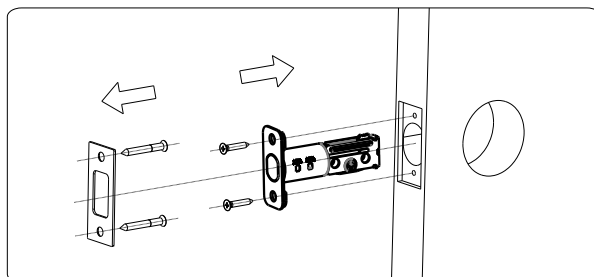

X4 KA4*40

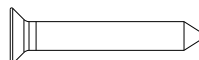

X2 KA4*20

3. Use a screw driver to try if deadbolt works smoothly.

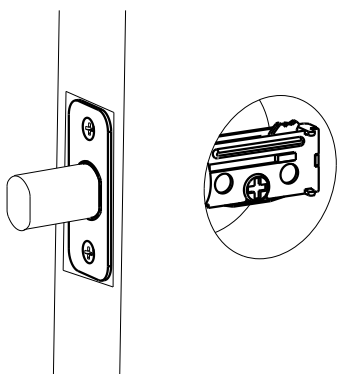

4. Holding the outside escutcheon flush to the door, position the key tailpiece and cable through the door hole.

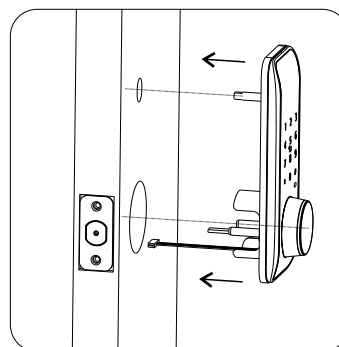

As you position the outside escutcheon, route the cable through 2-1/8" diameter hole.



NOTE: Cable must go through door hole under the bolt.

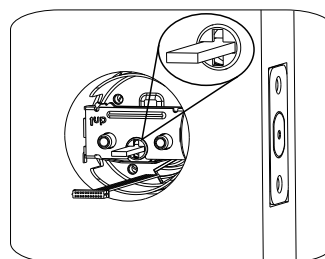

NOTE:
Bolt must be in retracted (unlocked) position.
Note horizontal orientation of key tailpiece.

Installation

5. Position the inside mounting plate by first routing the cable and connector through the mounting plate's cable hole.

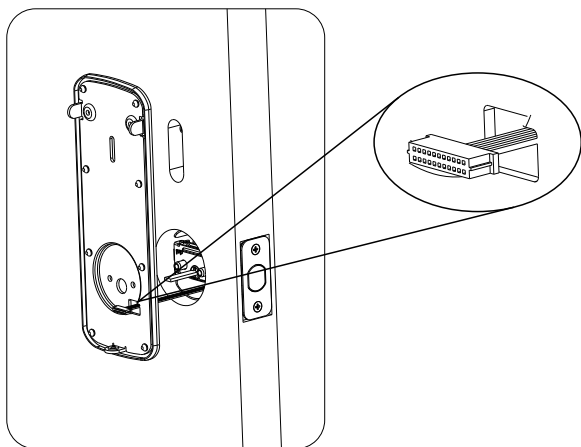

7. Place rotation shaft in hole on inside escutcheon.

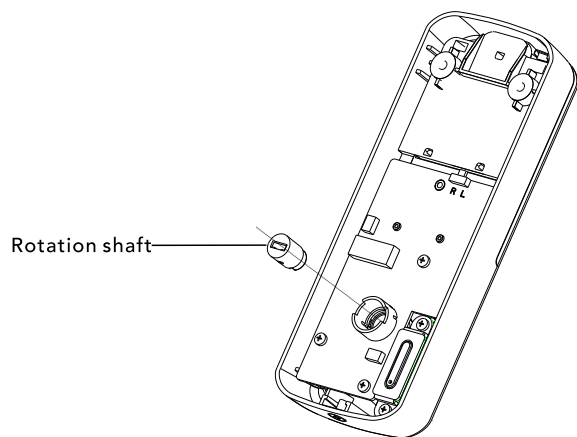

6. Secure both assemblies using 3 #8-32*30 screws, making sure that outside escutcheon is vertically aligned. Tighten securely with a #2 Philips screwdriver.

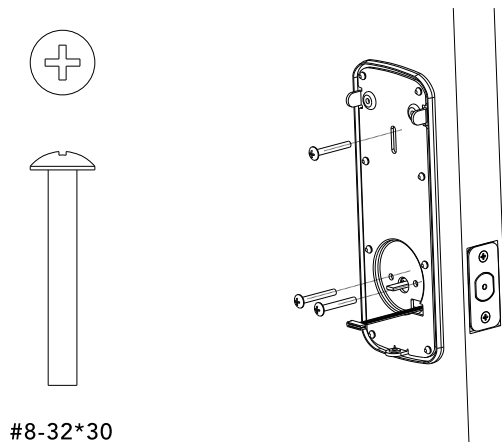

NOTE: Do not over-tighten.

8. Attach cable assembly to the inside escutcheon PCB by lining up notches on top of cable connector to slots on PCB connector. Press connector in firmly using thumbs until completely seated.

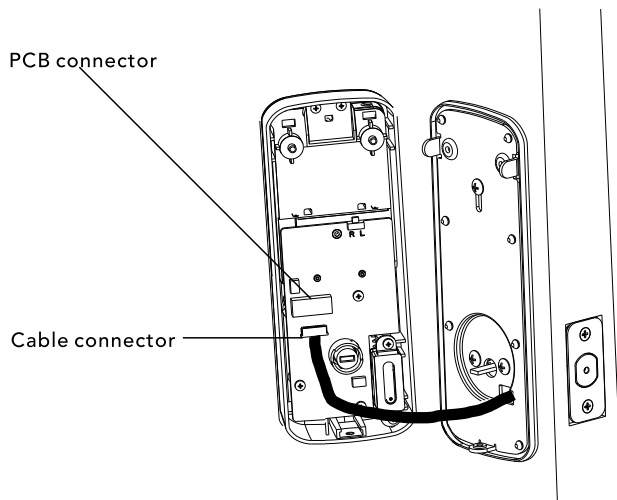

Installation

9. Install inside escutcheon on inside mounting plate.

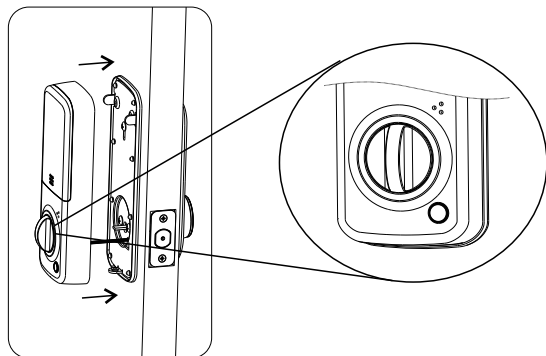

NOTE: The horizontal orientation of the tailpiece as you insert the inside escutcheon(thumb turn should be vertical)

11. Install wireless module (optional)

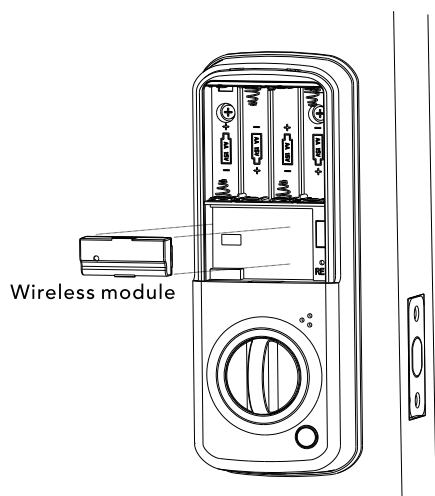

10. Secure using screws through the inside escutcheon onto the mounting plate.

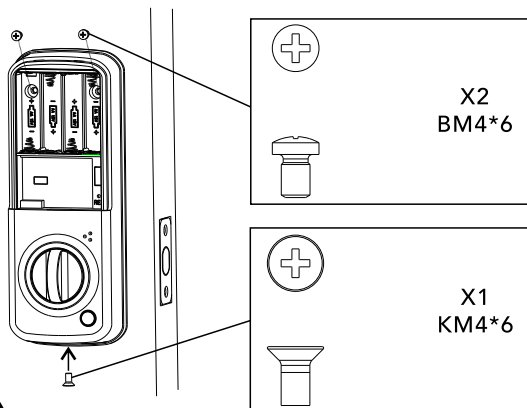

NOTE: Testing operation using override key and thumb turn before installing batteries, see if bolt works smoothly.

12. Insert four AA alkaline batteries. The lock responds, touchscreen lights up. Then install battery cover.

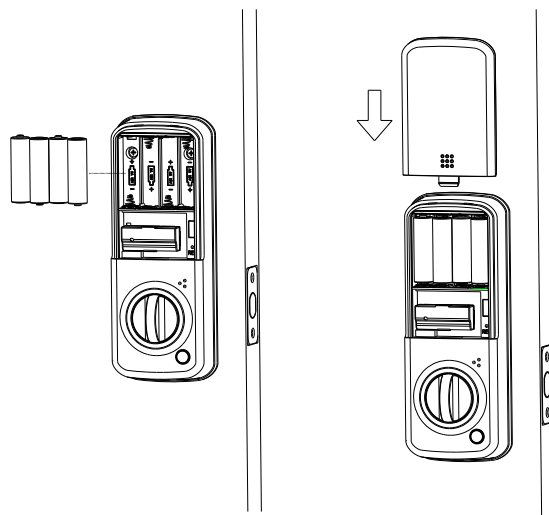

Congratulations, you have installed the Alfred DB2-B Touch Screen Deadbolt!

Turn sheet over for Programming Instructions to customize your product.